

EST.
1877

Slumber Lite

Travel Cot

IMPORTANT

BEFORE ASSEMBLING THIS COT READ AND UNDERSTAND THE INSTRUCTIONS.

DO NOT USE MATTRESS OTHER THAN THE ONE SUPPLIED BY THE MANUFACTURER. INCORRECT MATTRESS CAN CAUSE DEATH.

USE ONLY ACCESSORIES AS RECOMMENDED BY THE MANUFACTURERS.

ENSURE THE TOP RAILS AND BASE ARE FULLY LOCKED.

STOP USING THIS COT IF ANY PART OF THE COT IS BROKEN, TORN OR MISSING.

KEEP THESE INSTRUCTIONS IN A SAFE PLACE FOR FUTURE REFERENCE.

Silver Cross[®]

IMPORTANT – READ THE INSTRUCTIONS CAREFULLY BEFORE USE AND KEEP FOR FUTURE REFERENCE

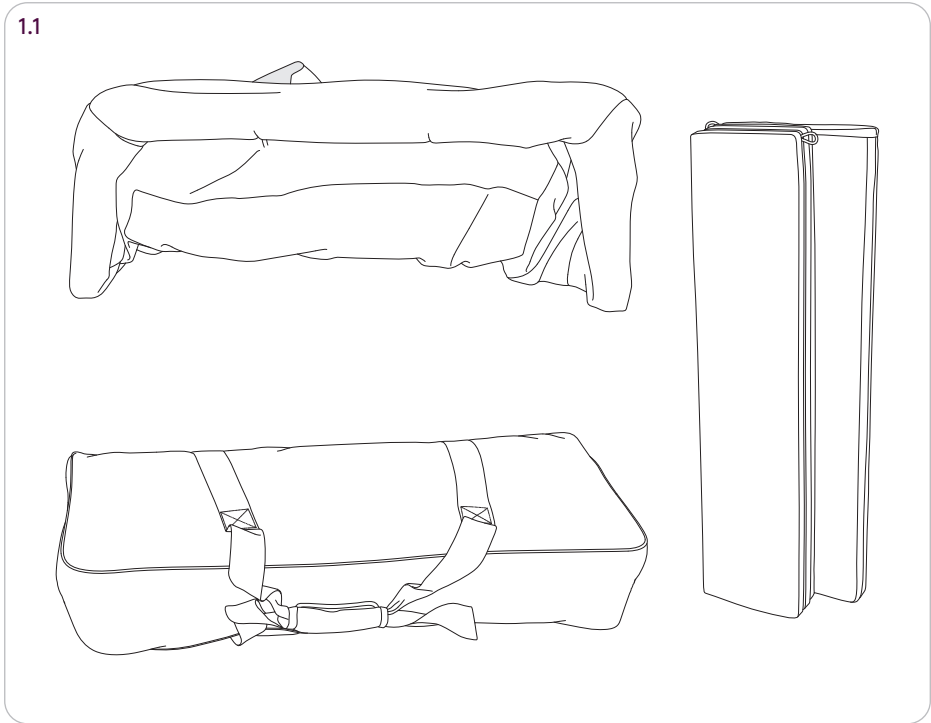

2.1

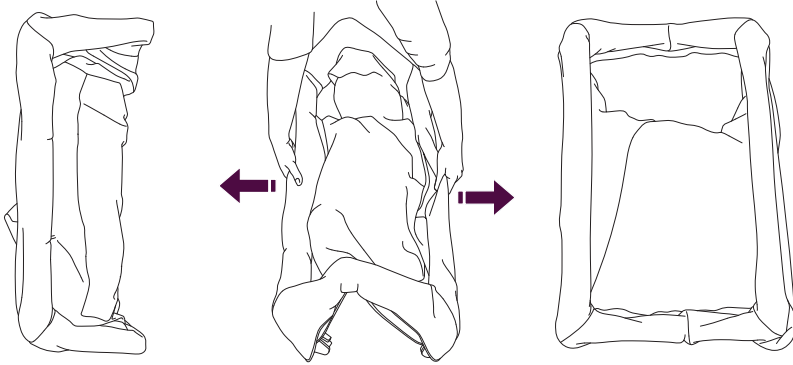

2.2

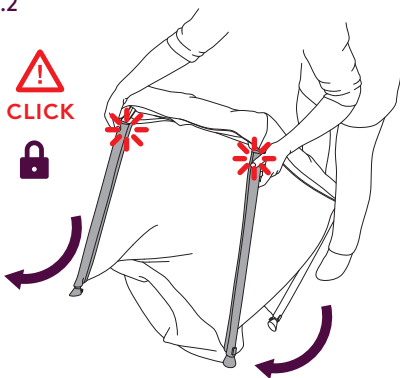

2.3

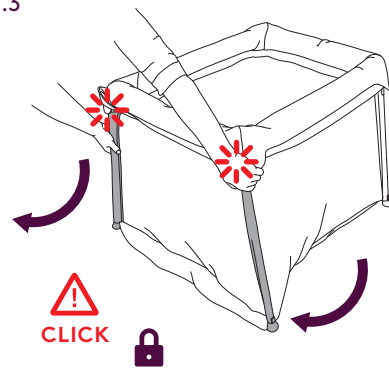

2.4

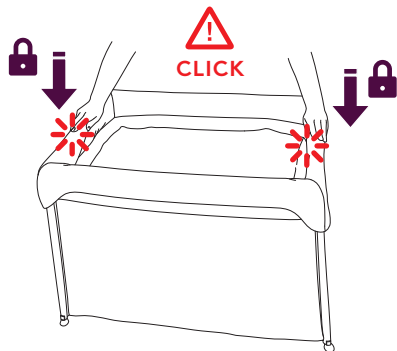

2.5

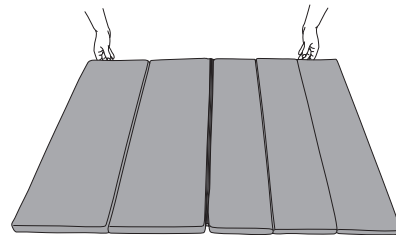

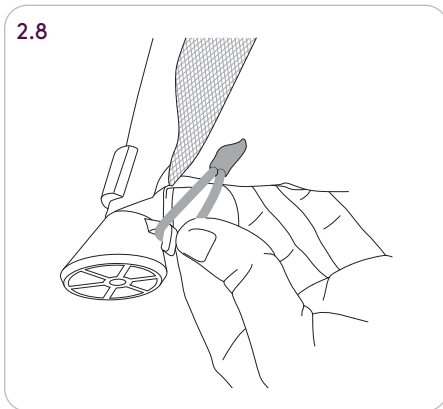
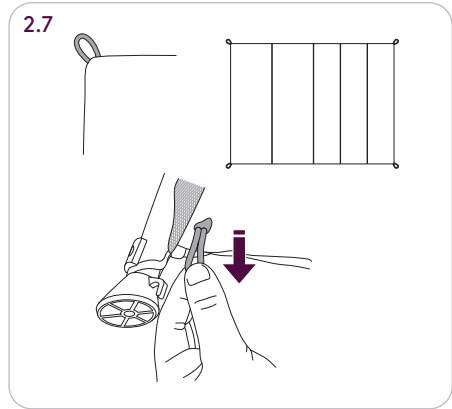
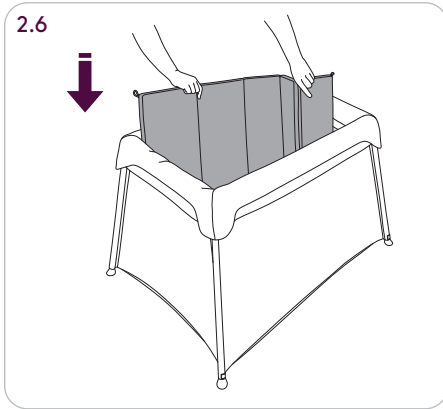

3.1

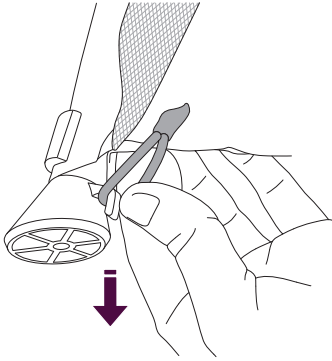

3.2

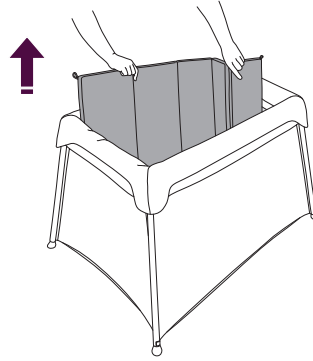

3.3

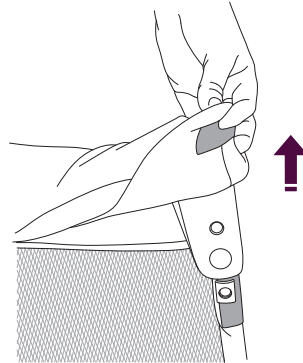
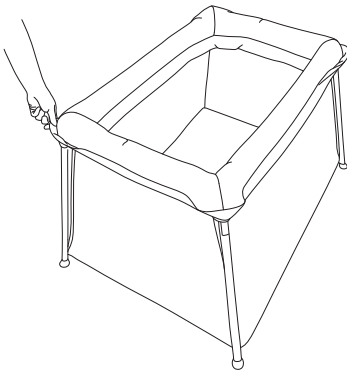

3.4

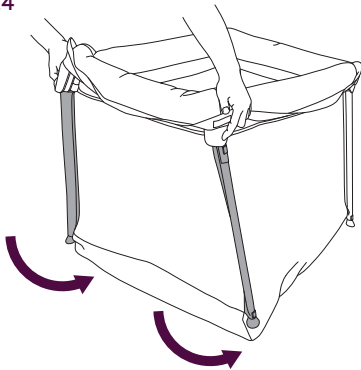

3.5

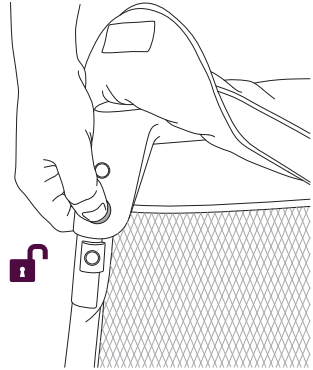

3.6

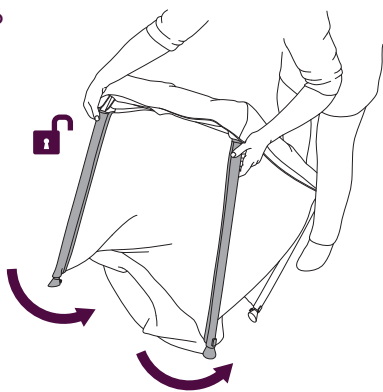

3.7

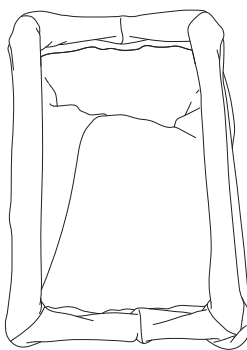

3.8

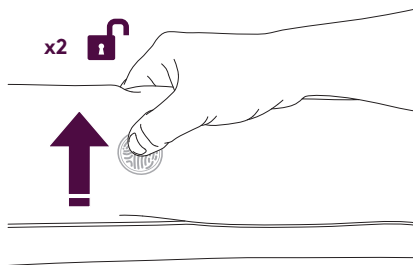
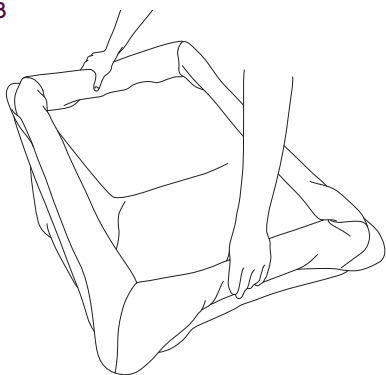

3.9

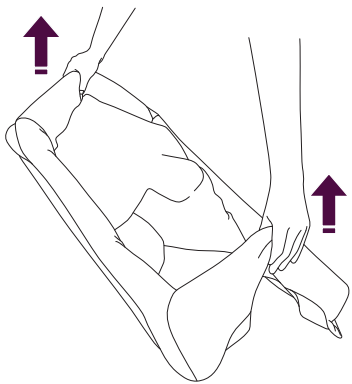

3.10

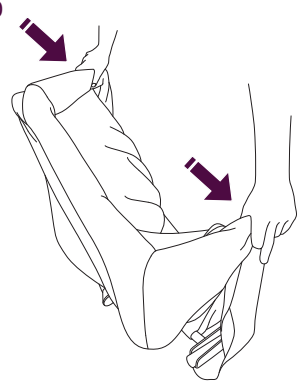

3.11

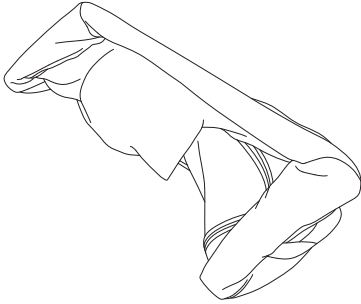

4.1

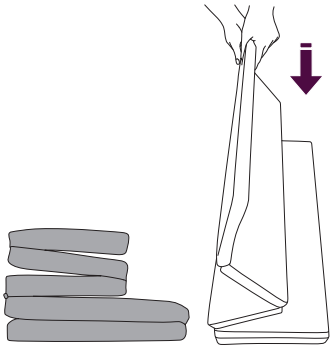

4.2

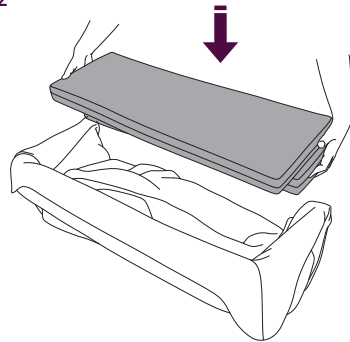

4.3

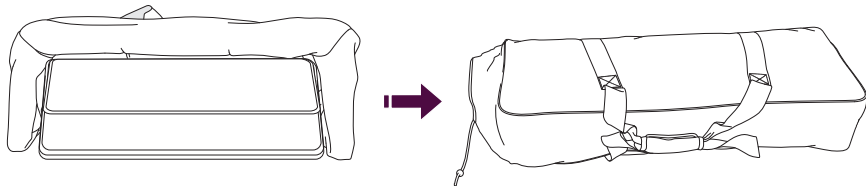

IMPORTANT: KEEP THESE INSTRUCTIONS FOR FUTURE REFERENCE

Safety notes

Your Slumber Lite Travel Cot is a high quality Silver Cross product.

It complies with AS/NZS 2195:2010. With correct use and maintenance will give good service. If, however you should have any problems with your product, please contact your Silver Cross retailer who will take appropriate action.

THIS PLAYPEN IS SUITABLE FOR CHILDREN FROM BIRTH TO 36 MONTHS.

Only use replacement parts and accessories supplied or recommended by Silver Cross.

! WARNING
BEFORE ASSEMBLING THIS COT READ AND UNDERSTAND THE INSTRUCTIONS.

! WARNING
DO NOT USE MATTRESS OTHER THAN THE ONE SUPPLIED BY THE MANUFACTURER.

! WARNING
INCORRECT MATTRESS CAN CAUSE DEATH.

! WARNING
USE ONLY ACCESSORIES AS RECOMMENDED BY THE MANUFACTURERS.

! WARNING
STOP USING THIS COT IF ANY PART OF THE COT IS BROKEN, TORN OR MISSING.

! WARNING
KEEP THESE INSTRUCTIONS IN A SAFE PLACE FOR FUTURE REFERENCE.

! WARNING
USE ONLY ACCESSORIES AS RECOMMENDED BY THE SUPPLIER.

! WARNING
ENSURE THE TOP RAILS AND BASE ARE FULLY LOCKED.

! WARNING
DO NOT USE THIS COT IF ANY PART OF THE COT IS BROKEN, TORN OR MISSING.

! WARNING
NEVER ADD AN EXTRA MATTRESS AS THIS MAY CAUSE SUFFOCATION.

! WARNING
FOLLOW THE ASSEMBLY AND LOCKING PROCEDURES ON INSTRUCTION MANUAL.

⚠️ WARNING

CHECK BEFORE EACH USE THAT THE COT IS CORRECTLY ASSEMBLED AND LOCKING DEVICES ARE FULLY ENGAGED.

⚠️ WARNING

THIS PRODUCT COMPLIES WITH AS/NZS 2195:2010

⚠️ WARNING

USE ONLY THE MATTRESS SUPPLIED BY THE MANUFACTURER.

⚠️ WARNING

INCORRECT MATTRESS CAN CAUSE DEATH.

⚠️ WARNING

KEEP CHILDREN AWAY WHILE ASSEMBLING/DISASSEMBLING THE COT.

⚠️ WARNING

DO NOT LEAVE ANYTHING ON THE FOLDING COT (SUCH AS TOYS) THAT PROVIDE A FOOTHOLD.

⚠️ WARNING

DO NOT USE THE FOLDING COT NEAR NAKED HEAT SOURCES, BAR HEATERS, OPEN FIRES OR EXPOSED FLAMES.

⚠️ WARNING

KEEP THE FOLDING COT CLEAR OF TRAILING CABLES AND HANGING CORDS.

⚠️ WARNING

KEEP MEDICATION AND SMALL ITEMS THAT A CHILD COULD CHOKE ON, AWAY FROM THE COT.

⚠️ WARNING

FOLDING COTS WITH PADDED RIMS SHOULD NOT BE USED IF THE COVERING MATERIAL HAS BEEN BITTEN THROUGH.

⚠️ WARNING

INFANTS CAN SUFFOCATE

- IN GAPS BETWEEN A MATTRESS TOO SMALL OR TOO THICK AND PRODUCT SIDES
- ON SOFT BEDDING

NEVER ADD A MATTRESS, PILLOW, COMFORTER, OR PADDING.

⚠️ WARNING

FAILURE TO FOLLOW THESE WARNINGS AND THE INSTRUCTIONS COULD RESULT IN SERIOUS INJURY OR DEATH.

⚠️ WARNING

MAKE SURE LATCHES ARE SECURE.

⚠️ WARNING

CHILD CAN BECOME ENTRAPPED AND DIE WHEN IMPROVISED NETTING OR COVERS ARE PLACED ON TOP OF PRODUCT. NEVER ADD SUCH ITEMS TO CONFINE CHILD IN PRODUCT.

⚠️ WARNING

ALWAYS PROVIDE THE SUPERVISION NECESSARY FOR THE CONTINUED SAFETY OF YOUR CHILD. WHEN USED FOR PLAYING, NEVER LEAVE CHILD UNATTENDED.

⚠️ WARNING

TO REDUCE THE RISK OF SIDS, PAEDIATRICIANS RECOMMEND HEALTHY INFANTS BE PLACED ON THEIR BACK TO SLEEP, UNLESS OTHERWISE ADVISED BY YOUR PHYSICIAN.

⚠️ WARNING

BE AWARE OF THE RISK OF OPEN FIRE AND OTHER SOURCES OF STRONG HEAT, SUCH AS ELECTRIC BAR FIRES, GAS FIRES, ETC. IN THE NEAR VICINITY OF THE COT.

⚠️ WARNING

DO NOT LET YOUR CHILD CLIMB ON THIS PRODUCT.

⚠️ WARNING

NEVER LEAVE YOUR CHILD UNATTENDED.

⚠️ WARNING

ALWAYS ENSURE THAT THE ZIP OPENING IS FULLY CLOSED WHEN THE TRAVEL COT IS USED AS AN UNATTENDED SLEEPING DEVICE.

Care and maintenance

Frame - Always check your Silver Cross Travel Cot for signs of wear. Polish metal work with a clean, dry cloth.

Fabric - For fabric wash care instructions please refer to the care guide included with your Silver Cross Travel Cot.

Keep away from direct heat and strong sunlight. A certain degree of fading may occur over time through everyday use. Never machine wash, tumble dry, iron or bleach.

Silver Cross®

Premium Brands Pty Ltd, 10 Capital Court, Braeside Victoria 3195, Australia
silvercross.com.au

IM-RXB-201102-02r01 - SLUMBER LITE - AUSTRALIA